

# High Security Camlocks

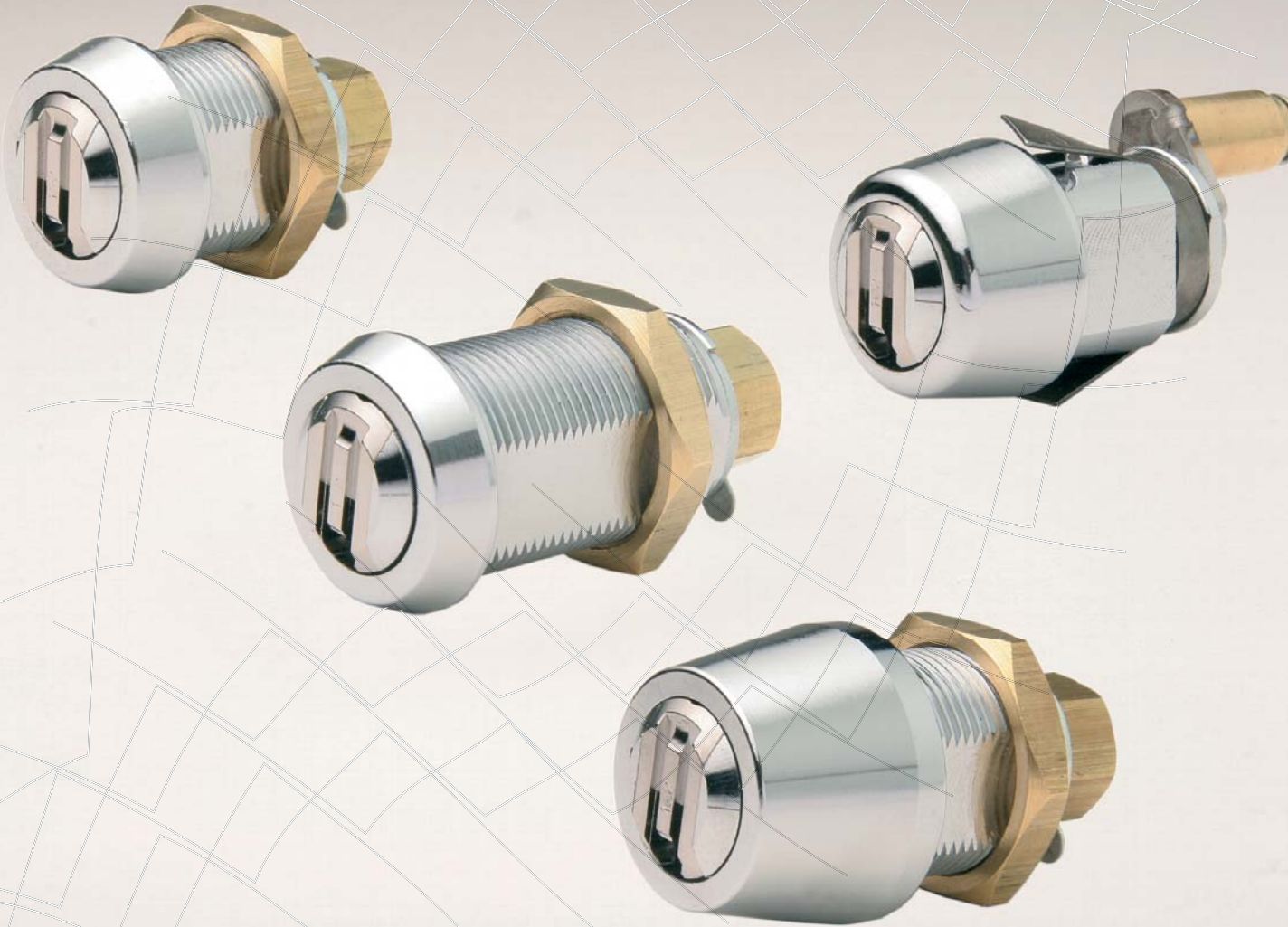

Manufactured by  
**Australian Lock Company Pty Ltd**

17 Doyle Ave, (PO Box 479) Unanderra NSW 2526, Australia.  
Tel: 61 2 4272 4922 Fax: 61 2 4272 4677

# The BiLock range of high security lock cylinders provide for applications that require optimum security with key restrictions and are fully compatible with each other.

## Camlock #3215 #3219 #32R19 #3227

Camlocks are designed as a high security alternative for use in the protection of money and electronic or sensitive material where a simple cam lock action is required. All camlocks offer either Standard or Quick Change Core (QCC) option.

### Typical Applications

Poker and gaming machines	Security key monitor	Communication cables and/or towers
Video machine	Alarm control cabinets	Personnel lockers
Cash boxes	Parking meters	Key storage cabinets
Vending machines	Petrol pump meters	Secure briefcases
Currency changers	Cash registers	Filing cabinets
Utility meter locks	Pay telephones	

### Security Advantages

- All models are SCEC endorsed to Class "C" security containers.
- The BiLock New Generation has strong legal protection with a standard patent granted covering the BiLock New Generation moveable element key through until 2019. This standard patent provides the highest level of legal protection available.
- Specialised (unique) proprietary key cutting and forming equipment supplied to accredited BiLock agents only.
- Virtually impossible to pick, rap or read codes through the keyway.
- All 12 pins are equal length, chisel shaped & contain false holes which must interact with two side bars simultaneously to operate lock.
- Dual bladed keyway is highly resistant to impressing.
- Powerful master keying capabilities provide over 16.7 million real key combinations per key profile.
- Manufacturer's Guarantee and warranty.
- Quality Assured manufacturer with exacting tolerances.
- A huge range of compatible cylinder types is available to suit most hardware on the market today.
- BiLock's 8,000 key head colour combination options ensure our systems provide easy visual key identification.
- Features BiLock's Quick Change Core (QCC) option.
- BiLock has received two Australian Design Awards for excellence.
- Recommended by many of Australia's leading architectural firms.

### Product Details

#### Materials

**Body:** Brass

**Plug:** Brass,

**Cams:** Zinc Plated Steel

**Key blank:** Nickel Silver

#### Finishes

Chrome Plate (CP)

#### Cams

**Four types available:**

**Straight:** 25-60mm

Offset: 28-40mm

Hook: 19-54mm

Spigot (2 Types)



Quality  
Endorsed  
Company  
ISO9001 Lic:QCEC21804  
SAI Global



Proudly designed and manufactured in Australia

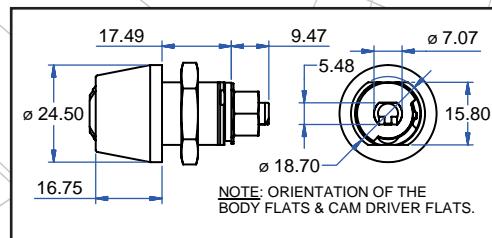

### #3215

#### Prod No. Operation

**32159** 90° Movement (12 pin)

**32159D** 180° Movement (12 pin) 2 Position Key Withdrawal

**32151** 180° Movement (12 pin)

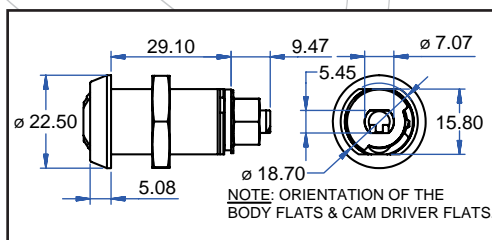

### #3219

#### Prod No. Operation

**32199** 90° Movement (12 pin)

**32199D** 90° Movement (12 pin) 2 Position Key Withdrawal

**32191** 180° Movement (12 pin)

**32R19** Government Approval "C" Class.

Information available on request.

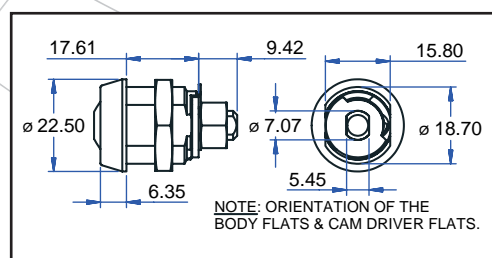

### #3227

#### Prod No. Operation

**32271** 180° Movement (8 Pin)

**32279** 90° Movement (8 Pin)

**Products are available in First Generation, First Generation QCC, New Generation and New Generation QCC.**